

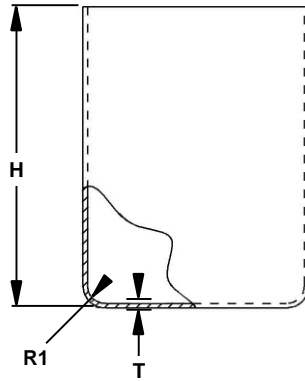

# MuMETAL® DEEP DRAWN CANS

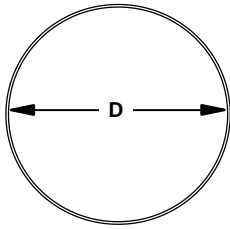

### CIRCULAR CAN DIMENSIONS:

D. \_\_\_\_\_

H. \_\_\_\_\_

T. \_\_\_\_\_

R1. \_\_\_\_\_

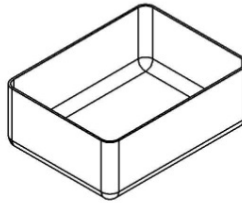
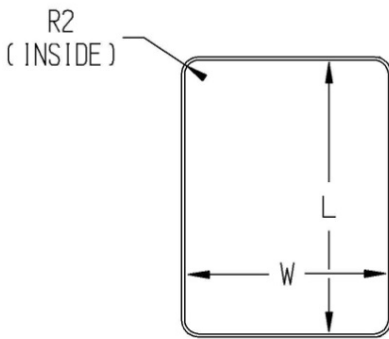

### RECTANGULAR CAN DIMENSIONS:

L. \_\_\_\_\_

W. \_\_\_\_\_

H. \_\_\_\_\_

R1. \_\_\_\_\_

R2. \_\_\_\_\_

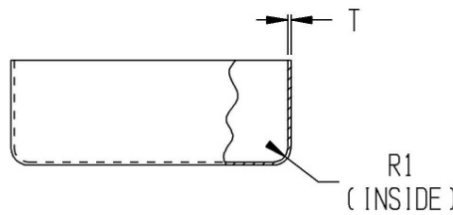
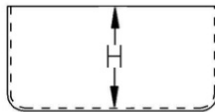

MATERIAL: \_\_\_\_\_

QUANTITY: \_\_\_\_\_

LEAD TIME: \_\_\_\_\_

FINISHING: \_\_\_\_\_

FLANGED LID:  INSIDE  OUTSIDE

### TOOL PAYMENT OPTIONS:

Amortize tool cost over first 5,000 – 10,000 cans

Upfront: cost for single or double tool

Upfront: full cost – customer owns the tool (RFQ)

Upfront: fully automatic tooling – reduces unit costs (RFQ)

- For annual volume less than 500 pieces; start-up, prototype tooling and annealing fixtures will be amortized in the per piece price, unless a separate charge is requested.
- For annual volume less than 20000 pieces there is a one-time charge to cover start-up, deep-draw tooling, first article samples, gauges and annealing fixtures.<sup>(1)</sup>
- For annual volume greater than 20000 pieces there is a one-time charge to cover start-up, double-wide deep-draw tooling, first article samples, gauges and annealing fixtures.<sup>(1)</sup>
- For high-speed, high volume, automated tooling (substantially lower piece price), please request a tooling quote.<sup>(1)</sup>

<sup>(1)</sup>Payment is due at time of order, or may be amortized over first 5,000 – 10,000 pieces.



## STANDARD STOCK RANGE

### DEEP DRAWN CIRCULAR CANS:

Part Number	Internal Dimensions				Nominal Thickness	
	Diameter		Depth			
	inches	[mm]	inches	[mm]	inches	[mm]
MUCAN032-119-185	1.19	[30,2]	1.85	[47,0]	.032	[0,8]
MUCAN032-119-137	1.19	[30,2]	1.37	[34,9]	.032	[0,8]
MUCAN032-119-113	1.19	[30,2]	1.13	[28,6]	.032	[0,8]
MUCAN032-119-082	1.19	[30,2]	0.82	[20,8]	.032	[0,8]
MUCAN032-131-106	1.31	[33,3]	1.06	[27,0]	.032	[0,8]
MUCAN032-096-076	0.96	[24,4]	0.76	[19,3]	.032	[0,8]
MUCAN032-075-075	0.75	[19,0]	0.75	[19,0]	.032	[0,8]
MUCAN032-154-205	1.54	[39,0]	2.05	[52,0]	.032	[0,8]
MUCAN032-195-154	1.95	[48,9]	1.54	[39,0]	.032	[0,8]
MUCAN032-232-256	2.32	[59,0]	2.56	[65,0]	.032	[0,8]
MUCAN032-346-173	3.46	[88,0]	1.73	[44,0]	.032	[0,8]

### DEEP DRAWN RECTANGULAR CANS:

Part Number	Internal Dimensions						Nominal Thickness	
	Length		Width		Depth			
	inches	[mm]	inches	[mm]	inches	[mm]	inches	[mm]
MUCAN020-136-111-095	1.36	[34,6]	1.11	[28,2]	0.95	[24,2]	.020	[0,5]
MUCAN020-111-091-089	1.11	[28,2]	0.91	[23,2]	0.89	[22,5]	.020	[0,5]
MUCAN039-090-067-070	0.90	[22,9]	0.67	[17,0]	0.70	[17,8]	.039	[1,0]

- Tolerances +/- 0.010" [0,25mm]
- These cans are our current range, however, we are constantly extending our range and it may be possible to manufacture your particular requirements from our standard tooling.
- Piercing/drilling of holes and cutouts can be made as required.
- Height of can could be adjusted - Please contact Magnetic Shield Corporation for MAX/MIN height range.
- Inside and outside flanged lids are available for most of our stock range cans upon request.

